

# Mileo 295

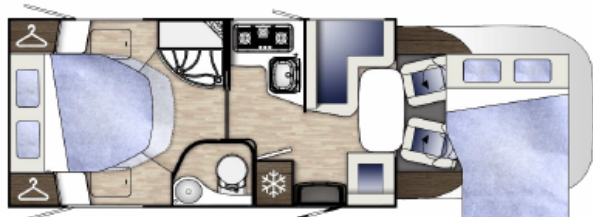

**benimar**  
2018



L: 699 cm  
W: 230 cm  
H: 289 cm

5  
 5  
 5

- Diesel heater
- Water boiler

## STRONG POINTS

- 5 driving places and just 6,99 long
- Electric roofbed 2 Pl (230kg max)
- Island sliding bed
- L shaped kitchen
- Large fridge 140l AES with separate 9 bottles (1.5l) compartment
- Extractor fan
- Door between bedroom and diningroom
- Bathroom with separate shower
- Big storage space with 2 locker doors

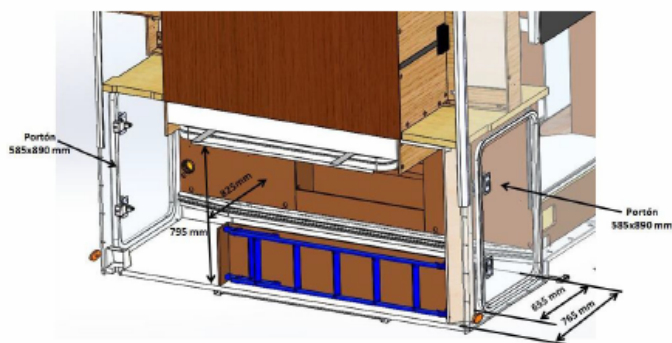

# Range Mileo

**benimar**  
2018



## CHASSIS

- FIAT with 2.3l engine 130HP and 6 speed gearbox
- Rear axle extra wide
- Front bumper same colour as the cab
- ABS
- Cab air conditioning
- Driver and passenger airbags
- Cruise control
- Electric and heated rear mirrors
- Central locking with remote control
- Electric windows
- Depth adjustable steering wheel
- Radio commands on the steering wheel
- Radio CD + Bluetooth + USB + touch screen
- Cab seats covered in same fabric as upholstery
- Day light
- Swivel seats
- Swivel reclining seats with armrests and height adjustment

## BODY

- Full polyester body
- Sidewalls and roof without wood (impossible to rot)
- 100% reinforced polyester profiled pot cab
- Skyview rooflight with sunblind and mosquito net (71x105cm)
- Dometic D-Lux double glazed windows
- Entrance door with 2 locking points + invisible hinges + central locking
- Multiposition telescopic table leg
- Inner body speakers
- Light in wardrobe
- Drawers in L-shaped kitchen
- Sink and 3 burner hob
- Large fridge 140l AES with separate 9 bottles (1.5l) compartment
- New rear spoiler
- Bicycle rack fasteners
- LED lights
- Soft closing drawers
- Lounge furniture with round wooden corners
- Electric roofbed 2 Pl (230kg max)
- Removable cushion covers
- Extractor fan
- Separate shower
- TV support
- 3 lounge cushions
- 2 bedroom pillows
- 1 kitchen set

## OPTIONAL PACKS

- FIAT engine 150HP
- Robotized gearbox (with ESP Traction Plus and Hill Descent)
- DELIVERY
- WINTER
- DESIGN
- SELEKT
- NORTHAUTOKAPP